

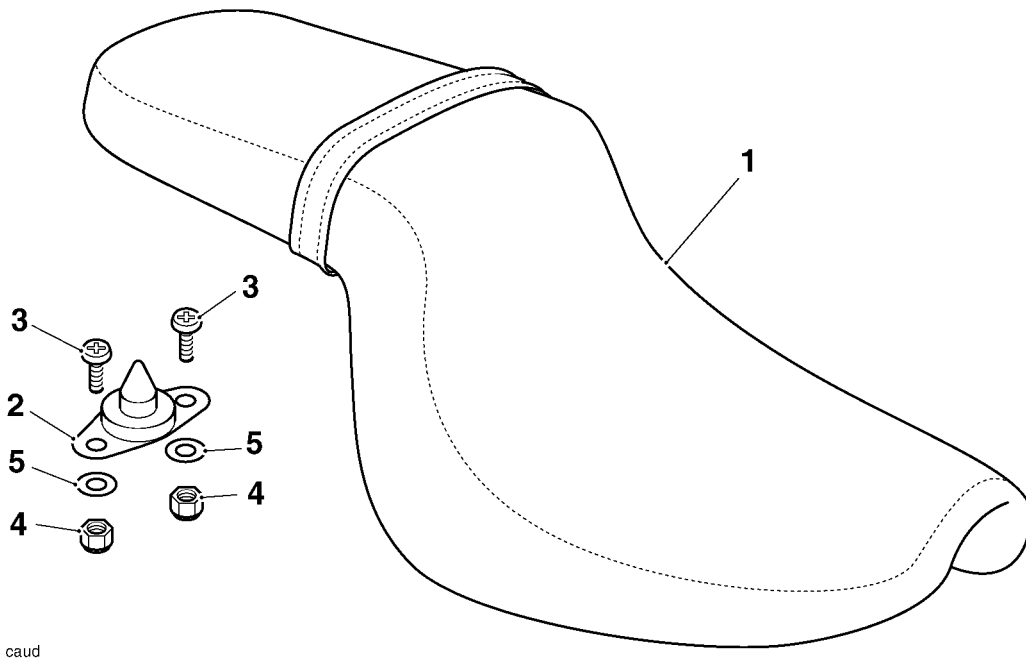

! WARNING: Always have Triumph approved parts, accessories and conversions fitted by a trained technician of an authorised Triumph dealer. The fitting of parts, accessories and conversions by a technician who is not of an authorised Triumph dealer may affect the handling, stability or other aspects of the motorcycle operation which may result in an accident causing injury or death.

! WARNING: This dual seat fitting is designed for use solely on the Triumph Bonneville America and should not be fitted to any other Triumph model or to any motorcycle of other manufacturers. Fitting this dual seat to any other Triumph model or to any motorcycle of other manufacturers may interfere with the rider and could affect the stability and handling of the motorcycle leading to an accident causing injury or death.

! WARNING: Throughout this operation, ensure that the motorcycle is stabilised and adequately supported to prevent the risk of injury from the motorcycle falling.



caud

1	Dual seat	1
2	Mounting bayonet	1
3	M6 x 20 bolts	2
4	M6 locknuts	2
5	Plastic washers	2

1. Remove the rear and front seats.
NOTE:
Retain the original seats for re-use if required.
2. Assemble the M6 bolts and plastic washers to the mounting bayonet as shown.
3. Fit to the rear mudguard using the two M6 locknuts to secure the assembly. Tighten to **6 Nm**.

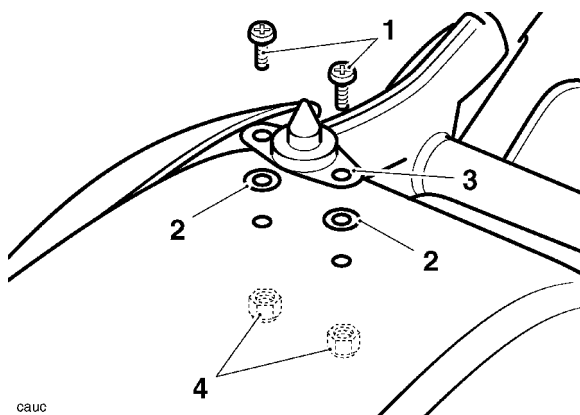

1. **M6 bolts**
 2. **Plastic washers**
 3. **Mounting bayonet**
 4. **M6 Locknuts**
4. Remove the owner's manual from the rear seat and locate in the pocket under the dual seat.
 5. Fit the dual seat ensuring the seat bayonet engages correctly.
 6. Refit the retaining bolt to the rear of the dual seat and tighten to **26 Nm**.